

\$425,000 - Sw-5-65-19 W4, Boyle

MLS® #A2203448

\$425,000

0 Bedroom, 0.00 Bathroom,
Land on 145.56 Acres

Boyle, Boyle, Alberta

Prime 146.56-Acre Farmland Near Boyle!
Located just one mile west of Boyle, this parcel offers farmland with exceptional convenience to town. The proximity to Boyle presents potential for future opportunities. The quarter section is slightly reduced from 160 acres due to a subdivision with a home on the west side of the quarter section. Whether you're expanding your farming operation, looking for an investment, or seeking land near town, this property is a fantastic opportunity!

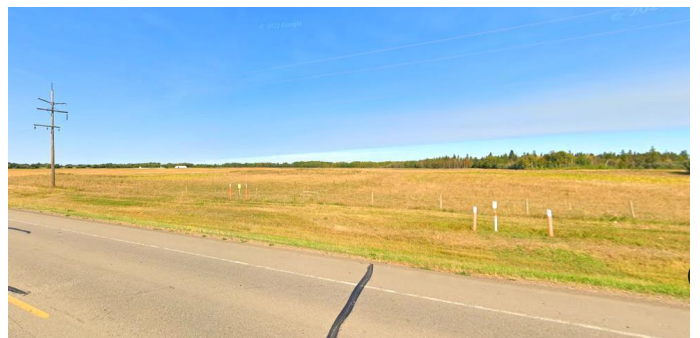

Essential Information

MLS® #	A2203448
Price	\$425,000
Bathrooms	0.00
Acres	145.56
Type	Land
Sub-Type	Commercial Land
Status	Active

Community Information

Address	Sw-5-65-19 W4
Subdivision	Boyle
City	Boyle
County	Athabasca County
Province	Alberta
Postal Code	T0A 0M0

Additional Information

Date Listed	March 18th, 2025
Days on Market	143
Zoning	Agriculture

Listing Details

Listing Office	RE/MAX LA BICHE REALTY
----------------	------------------------

Data is supplied by Pillar 9â„¢ MLS® System. Pillar 9â„¢ is the owner of the copyright in its MLS® System. Data is deemed reliable but is not guaranteed accurate by Pillar 9â„¢. The trademarks MLS®, Multiple Listing Service® and the associated logos are owned by The Canadian Real Estate Association (CREA) and identify the quality of services provided by real estate professionals who are members of CREA. Used under license.